

Customer Name: \_\_\_\_\_ Date: \_\_\_\_\_

Application Number: \_\_\_\_\_ Revision: \_\_\_\_\_

Project: \_\_\_\_\_

Material: \_\_\_\_\_

Prepared By: \_\_\_\_\_ Email: \_\_\_\_\_

	Dimension	General Guidelines	Recommended Size
W	Wall Thickness	Minimum 0.150" (3.81mm)	
B	Shear Length	0.020" – 0.080" (0.51mm - 2.03mm)	
A	Shear Width	0.016" – 0.030" (0.41mm - 0.76mm)	
T	Tongue Width	Minimum 0.075" (1.91mm)	
M	Flash Trap Width	2A	
F	Flash Trap Lead-In Depth	Minimum 0.5B + B	
L	Lead-in	Minimum 0.050" (1.27mm)	
S	Side Wall Width	Minimum 0.040" (1.02mm)	
C	Clearance	0.005" per side (0.13mm)	

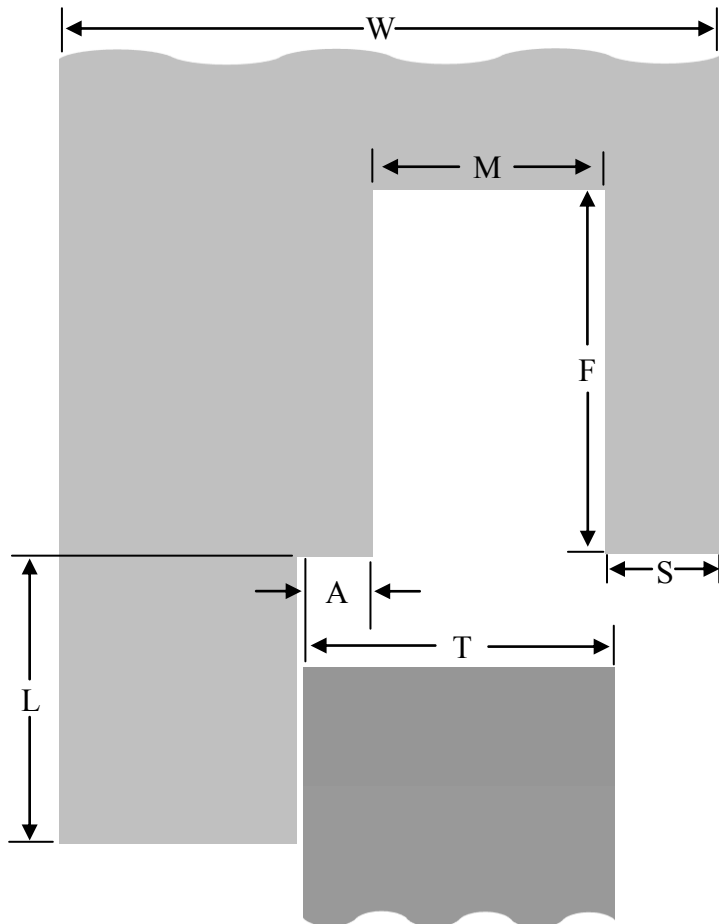

The spin shear with flash trap offers good flash control and a very strong mechanical weld.

This joint is preferred when one part has a thicker wall width than the other.

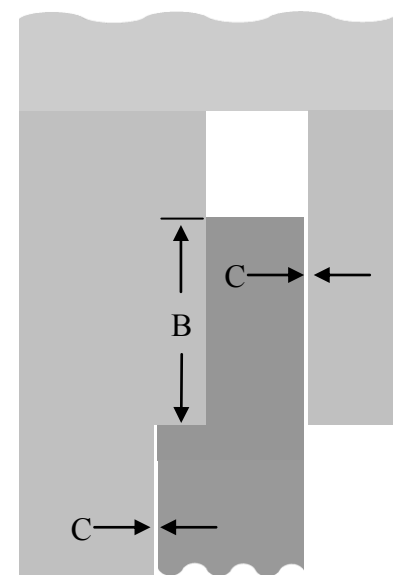

**Collapsed**